

**Commons Act 2006: Section 15**

**Application for the registration of land as a Town or Village Green**

Official stamp of registration authority indicating valid date of receipt:

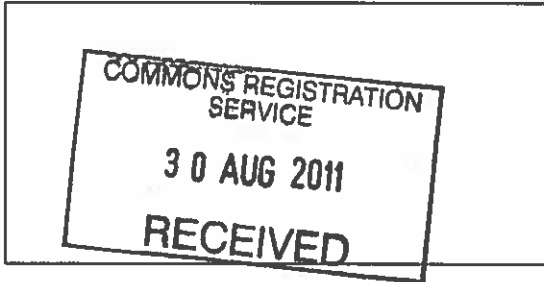

Application number:

Register unit No(s):

VG number allocated at registration:

(CRA to complete only if application is successful)

Applicants are advised to read the 'Guidance Notes for the completion of an Application for the Registration of land as a Town or Village Green' and to note the following:

- All applicants should complete questions 1–6 and 10–11.
- Applicants applying for registration under section 15(1) of the 2006 Act should, in addition, complete questions 7–8. Section 15(1) enables any person to apply to register land as a green where the criteria for registration in section 15(2), (3) or (4) apply.
- Applicants applying for voluntary registration under section 15(8) should, in addition, complete question 9.

**1. Registration Authority**

To the

CUMBRIA COUNTY COUNCIL  
COMMONS REGISTRATION DEPT  
NISI PRIUS BUILDING. THE COURTS  
CARTHURTON CUMBRIA CA3 8LZ

**Note 1**  
Insert name of registration authority.

**Note 2**

If there is more than one applicant, list all names. Please use a separate sheet if necessary. State the full title of the organisation if a body corporate or unincorporate.

If question 3 is not completed all correspondence and notices will be sent to the first named applicant.

**2. Name and address of the applicant**

Name:

ON BEHALF OF CUMREW PARISH COUNCIL

Full postal address:

BRAMPTON  
CUMBERIA  
Postcode CA8

Telephone number:   
(incl. national dialling code)

Fax number:   
(incl. national dialling code)

E-mail address:

**3. Name and address of solicitor, if any**

Name:

Firm:

Full postal address:

Post code

Telephone number:   
(incl. national dialling code)

Fax number:   
(incl. national dialling code)

E-mail address:

**Note 3**

This question should be completed if a solicitor is instructed for the purposes of the application. If so all correspondence and notices will be sent to the person or firm named here.

**Note 4**

*For further advice on the criteria and qualifying dates for registration please see section 4 of the Guidance Notes.*

*\* Section 15(6) enables any period of statutory closure where access to the land is denied to be disregarded in determining the 20 year period.*

**4. Basis of application for registration and qualifying criteria**

If you are the landowner and are seeking voluntarily to register your land please tick this box and move to question 5.

Application made under section 15(8):

If the application is made under section 15(1) of the Act, please tick one of the following boxes to indicate which particular subsection and qualifying criterion applies to the case.

Section 15(2) applies:

Section 15(3) applies:

Section 15(4) applies:

If section 15(3) or (4) applies please indicate the date on which you consider that use as of right ended.

If section 15(6)\* applies please indicate the period of statutory closure (if any) which needs to be disregarded.

**5. Description and particulars of the area of land in respect of which application for registration is made**

Name by which usually known:

CUMREW VILLAGE GREEN AND  
FELLSIDE LONNIN

Location:

THE CENTRE OF CUMREW VILLAGE  
MAP REF NY 552513 SHEET 86

Shown in colour on the map which is marked and attached to the statutory declaration.

Common land register unit number (if relevant) \*

**6. Locality or neighbourhood within a locality in respect of which the application is made**

Please show the locality or neighbourhood within the locality to which the claimed green relates, either by writing the administrative area or geographical area by name below, or by attaching a map on which the area is clearly marked:

MAIN STREET, CUMREW VILLAGE  
PARISH OF CUMREW + CROSSLATTON  
O/S MAP REF NY 552513 SHEET 86  
POST CODE CA8 9A

Tick here if map attached:

**Note 5**

The accompanying map must be at a scale of at least 1:2,500 and show the land by distinctive colouring to enable it to be clearly identified.

\* Only complete if the land is already registered as common land.

**Note 6**

It may be possible to indicate the locality of the green by reference to an administrative area, such as a parish or electoral ward, or other area sufficiently defined by name (such as a village or street). If this is not possible a map should be provided on which a locality or neighbourhood is marked clearly.

**7. Justification for application to register the land as a town or village green**

**Note 7**

Applicants should provide a summary of the case for registration here and enclose a separate full statement and all other evidence including any witness statements in support of the application.

This information is not needed if a landowner is applying to register the land as a green under section 15(8).

Indulgence by a significant number of inhabitants of Cumrew as of right in lawful sports and pastimes under section 15(2) of the Commons Act 2006 as witnessed by the thirty four (34) enclosed signed statements. Showing use for activities including walking, ballgames, picnicing, bird and mammal watching by a total of forty two people extending from 1980 to 2011

**Note 8**

*Please use a separate sheet if necessary.*

*Where relevant include reference to title numbers in the register of title held by the Land Registry.*

*If no one has been identified in this section you should write "none"*

*This information is not needed if a landowner is applying to register the land as a green under section 15(8).*

**Note 9**

*List all such declarations that accompany the application. If none is required, write "none".*

*This information is not needed if an application is being made to register the land as a green under section 15(1).*

**Note 10**

*List all supporting documents and maps accompanying the application. If none, write "none"*

*Please use a separate sheet if necessary.*

**8. Name and address of every person whom the applicant believes to be an owner, lessee, tenant or occupier of any part of the land claimed to be a town or village green**

NONE

**9. Voluntary registration – declarations of consent from 'relevant leaseholder', and of the proprietor of any 'relevant charge' over the land**

**10. Supporting documentation**

SEE ATTACHED LIST OF 23 LETTERS  
& MAPS REPRESENTING 34 INHABITANTS  
IN A VILLAGE OF 42 PEOPLE

**11. Any other information relating to the application**

[Empty box for additional information]

**Note 11**

*If there are any other matters which should be brought to the attention of the registration authority (in particular if a person interested in the land is expected to challenge the application for registration). Full details should be given here or on a separate sheet if necessary.*

**Note 12**

*The application must be signed by each individual applicant, or by the authorised officer of an applicant which is a body corporate or unincorporate.*

Date:

30.8.11

Signatures:

[Redacted signature]  
ON BEHALF OF CAMDEN  
PARISH COUNCIL

**REMINDER TO APPLICANT**

**You are advised to keep a copy of the application and all associated documentation. Applicants should be aware that signature of the statutory declaration is a sworn statement of truth in presenting the application and accompanying evidence. The making of a false statement for the purposes of this application may render the maker liable to prosecution.**

**Data Protection Act 1998**

*The application and any representations made cannot be treated as confidential. To determine the application it will be necessary for the registration authority to disclose information received from you to others, which may include other local authorities, Government Departments, public bodies, other organisations and members of the public.*

## Statutory Declaration In Support

*To be made by the applicant, or by one of the applicants, or by his or their solicitor, or, if the applicant is a body corporate or unincorporate, by its solicitor, or by the person who signed the application.*

<sup>1</sup> Insert full name  
(and address if not  
given in the  
application form).

I, JAMES ANTHONY FOWLER, solemnly and sincerely declare as follows:—

<sup>2</sup> Delete and adapt  
as necessary.

1.<sup>2</sup> I am ((the person (one of the persons) who (has) (have) signed the foregoing application)) ((the solicitor to (the applicant) (<sup>3</sup> one of the applicants))).

<sup>3</sup> Insert name if  
Applicable

2. The facts set out in the application form are to the best of my knowledge and belief fully and truly stated and I am not aware of any other fact which should be brought to the attention of the registration authority as likely to affect its decision on this application, nor of any document relating to the matter other than those (if any) mentioned in parts 10 and 11 of the application.

3. The map now produced as part of this declaration is the map referred to in part 5 of the application.

<sup>4</sup> Complete only in  
the case of  
voluntary  
registration (strike  
through if this is not  
relevant)

4.<sup>4</sup> ~~I hereby apply under section 15(8) of the Commons Act 2006 to register as a green the land indicated on the map and that is in my ownership. I have provided the following necessary declarations of consent:—~~

- ~~(i) a declaration of ownership of the land;~~
- ~~(ii) a declaration that all necessary consents from the relevant leaseholder or proprietor of any relevant charge over the land have~~

Cont/



~~been received and are exhibited with this declaration; or  
(iii) where no such consents are required, a declaration to that effect.~~

And I make this solemn declaration, conscientiously believing the same to be true, and by virtue of the Statutory Declarations Act 1835.

Declared by the said JAMES FOWLER )  
at Fell View, Cummer )  
Brampton )  
this 19<sup>th</sup> day of August 2011 )

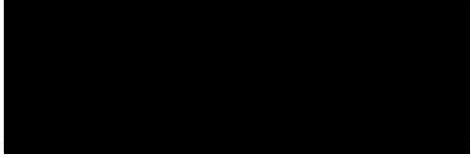

Signature of Declarant

Before me \* VIVIENNE CLOUGH

Signature:



Address:

[Redacted] CUMMER  
BRAMPTON

Qualification:

SOLICITOR

\* The statutory declaration must be made before a justice of the peace, practising solicitor, commissioner for oaths or notary public.

Signature of the statutory declaration is a sworn statement of truth in presenting the application and accompanying evidence.

**REMINDER TO OFFICER TAKING DECLARATION:**

*Please initial all alterations and mark any map as an exhibit*

## Statutory Declaration In Support

To be made by the applicant, or by one of the applicants, or by his or their solicitor, or, if the applicant is a body corporate or unincorporate, by its solicitor, or by the person who signed the application.

<sup>1</sup> Insert full name  
(and address if not  
given in the  
application form).

I, PHILIP LESLIE,<sup>1</sup> solemnly and sincerely declare as follows:—

ROBINSON  
ROSE COTTAGE  
CUMREW  
BRAMPTON CAB. 9DD

<sup>2</sup> Delete and adapt  
as necessary.

1.<sup>2</sup> I am ((the person (one of the persons) who (has) (have) signed the foregoing application)) ((the solicitor to (the applicant) (<sup>3</sup> one of the applicants)).

<sup>3</sup> Insert name if  
Applicable

2. The facts set out in the application form are to the best of my knowledge and belief fully and truly stated and I am not aware of any other fact which should be brought to the attention of the registration authority as likely to affect its decision on this application, nor of any document relating to the matter other than those (if any) mentioned in parts 10 and 11 of the application.

3. The map now produced as part of this declaration is the map referred to in part 5 of the application.

<sup>4</sup> Complete only in  
the case of  
voluntary  
registration (strike  
through if this is not  
relevant)

4.<sup>4</sup> ~~I hereby apply under section 15(8) of the Commons Act 2006 to register as a green the land indicated on the map and that is in my ownership. I have provided the following necessary declarations of consent:~~

- ~~(i) a declaration of ownership of the land;~~
- ~~(ii) a declaration that all necessary consents from the relevant leaseholder or proprietor of any relevant charge over the land have~~

Cont/

4 Continued

~~been received and are exhibited with this declaration; or  
(iii) where no such consents are required, a declaration to that effect.~~

And I make this solemn declaration, conscientiously believing the same to be true, and by virtue of the Statutory Declarations Act 1835.

Declared by the said PHILIP LESLIE ROBINSON  
at Fall View  
Cummer  
Brampton  
this 30th day of January 2017

  
Signature of Declarant

Before me \*  
 VIENNE CHOUGH  
Signature:

Address:  Cummer  
Brampton  
Qualification: Solicitor

\* The statutory declaration must be made before a justice of the peace, practising solicitor, commissioner for oaths or notary public.

Signature of the statutory declaration is a sworn statement of truth in presenting the application and accompanying evidence.

**REMINDER TO OFFICER TAKING DECLARATION:**

*Please initial all alterations and mark any map as an exhibit*

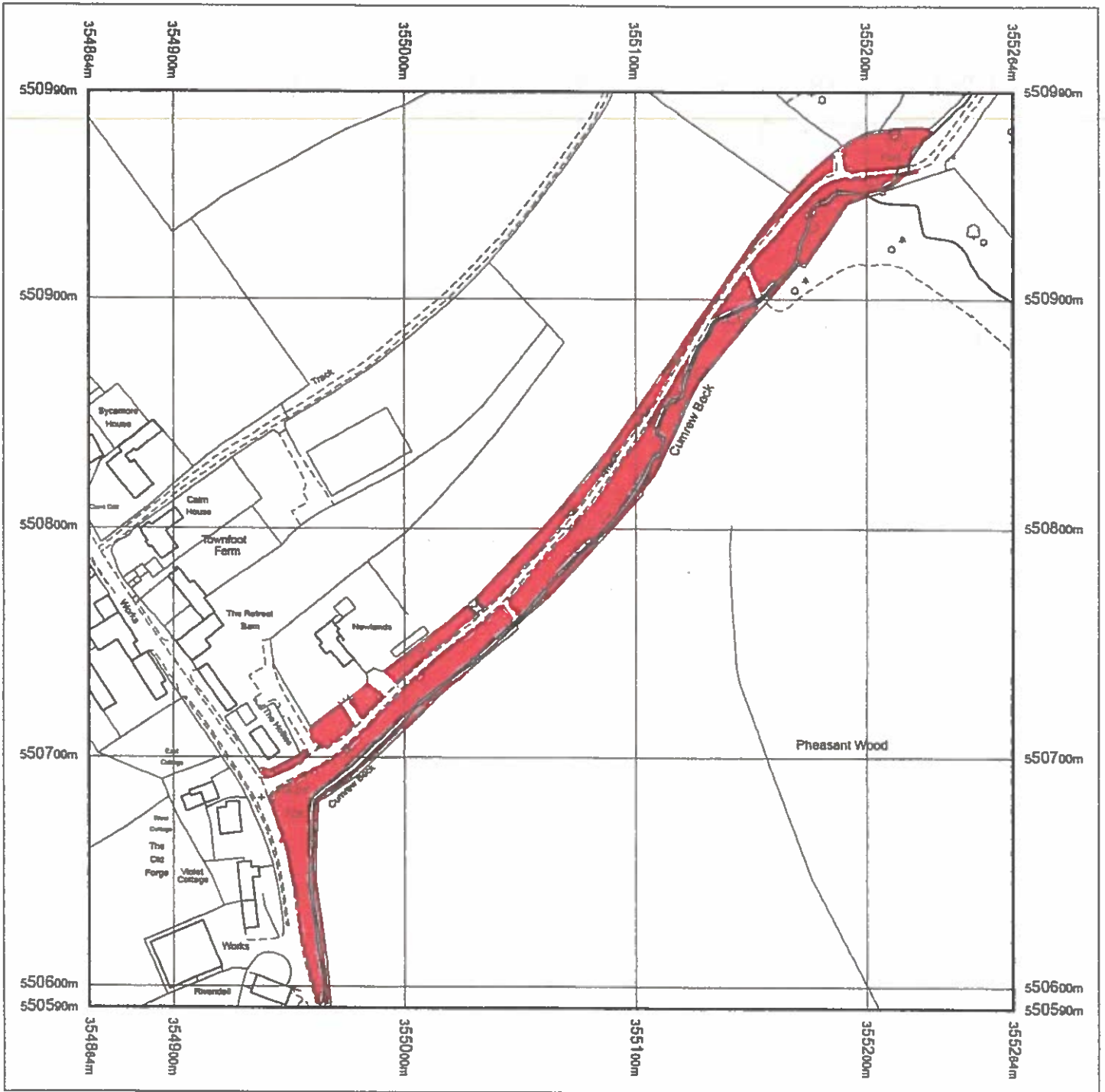

Amended plan 30<sup>th</sup> Nov. 2015

Produced 04.01.2011 from the Ordnance Survey National Geographic Database and incorporating surveyed revision available at this date. © Crown Copyright 2011.

Reproduction in whole or part is prohibited without the prior permission of Ordnance Survey.

Ordnance Survey, the OS Symbol and OS Sitemap are registered trademarks of Ordnance Survey, the national mapping agency of Great Britain.

The representation of a road, track or path is no evidence of a right of way.

The representation of features as lines is no evidence of a property boundary.

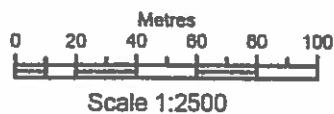

Supplied by: Carlisle Library  
 Serial number: 00075000  
 Centre coordinates: 355083.5 550790.5

Further information can be found on the OS Sitemap Information leaflet or the Ordnance Survey web site: [www.ordnancesurvey.co.uk](http://www.ordnancesurvey.co.uk)

This is the plan referred to in the attached declaration

Signed



Dated

26. 1. 2017

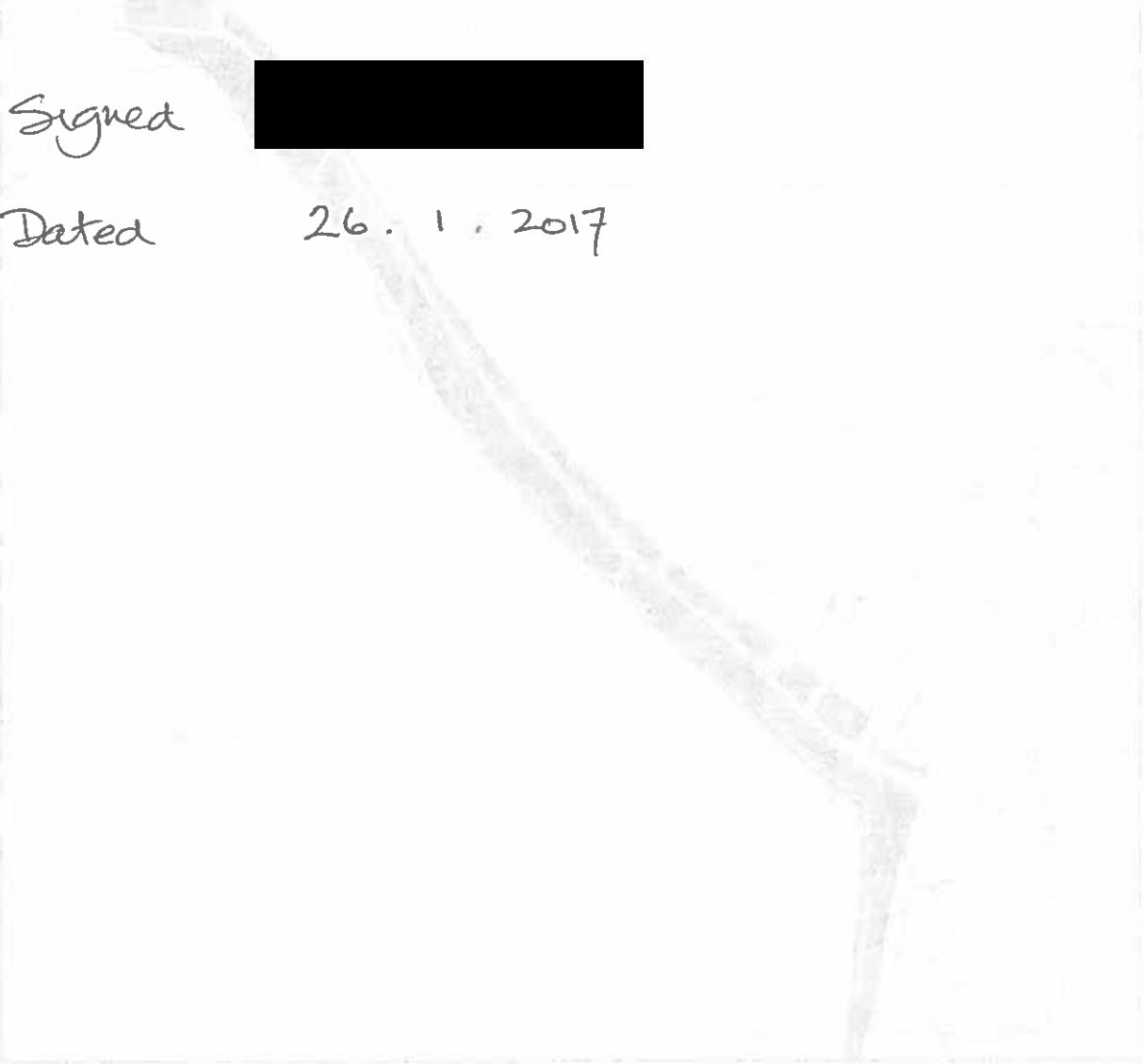

Scale 1:5000  
North arrow pointing up

2017/18

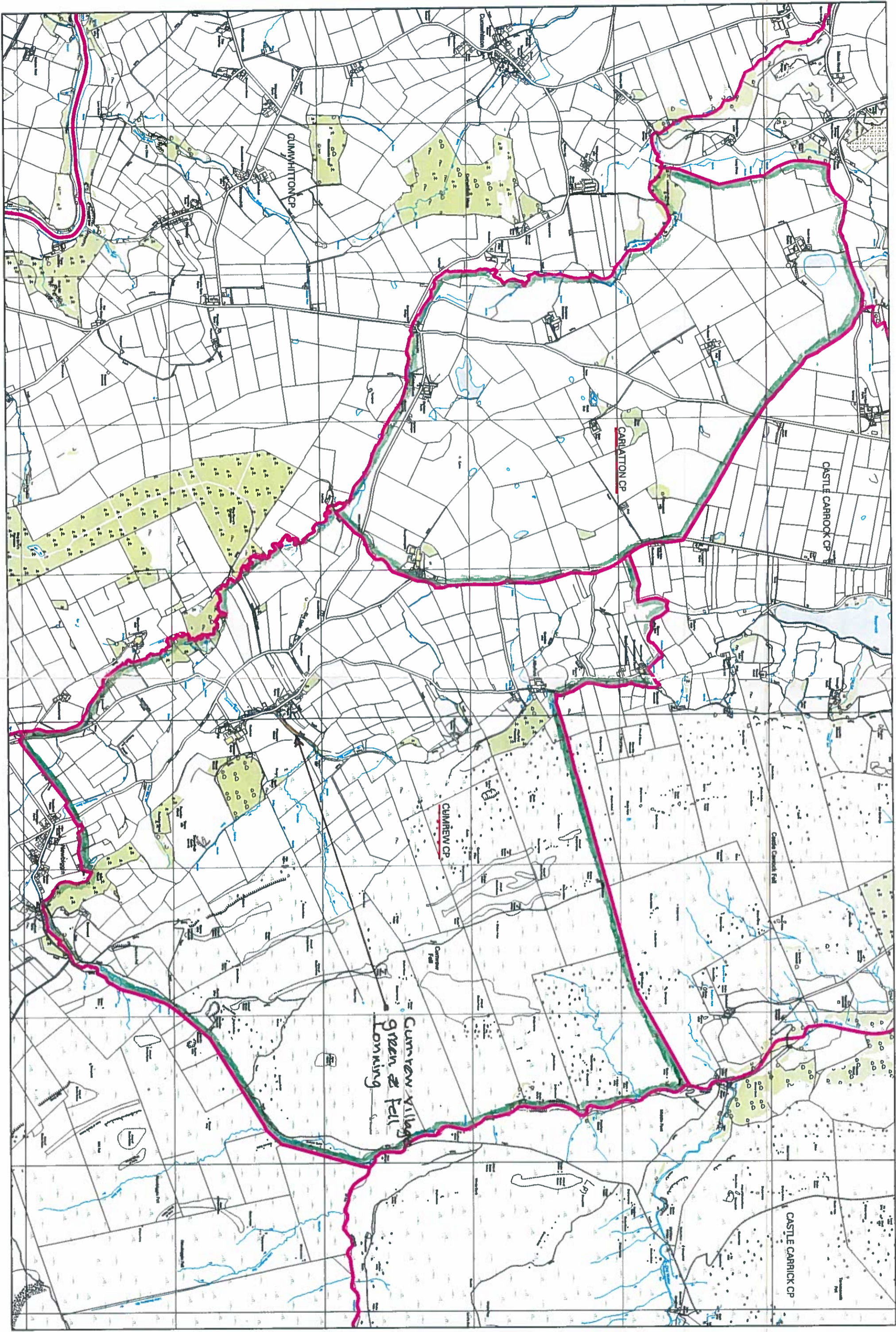

**EVIDENCE STATEMENTS RE: APPLICATION NO: NL0057 LAND AT CUMREW**

Name	Local Inhabitant	Lawful sports & pastimes	User as of right	for 20 yrs	up to date 05/03/08	frequency of use	other comments
Alan Sykes	yes	access to walk fells, grandchildren play	yes	16 years (no dates)		regular	
Ann Bellingham	yes	access to fells, grandchildren play	no mention	10 years (no dates)		regular	
Gordon and Janet Strong	yes	access, dog walking, cycling, picnics, play	yes	60 years (no dates)			
Fred and Sheila Brown	yes	bonfire parties, picnics, den building, play	yes	1960- present time			
Viv Clough	yes	access to fells, cat walking, sloe picking, cycling, bonfire, nature walks	yes	1994 - present time	30/05/2011		
Mike Clough	yes	access to the fells, walking, cat walking, blackberrying, cycling, bonfires, nature walks, home made swings and dens	yes	1994-present time	28/05/2011		
Guy and Shona Broome	yes	nature watching	no mention	2009			
Kirsty Hollings	yes	dog walking, access to fells, blackberrying, bird watching, bonfire parties, cycling, children playing.	yes	2005			
Andrew Hollings	yes	access to fells	yes	2005		daily	farmers use it to move their sheep to higher ground.
Elizabeth Fowler	yes	dog walking, nature walk	no mention	2006			farmers use it to take sheep to upland grazing areas
Susan Blake and Peter Long	yes	children playing and walking	no mention	2009		regular uses	
Phil and Lynne Robinson	yes	dog walking, blackberrying, bird watching, bonfire parties, cycling, children playing	yes	35 years			
Paul and Julia Jenner	yes	children playing, den building, dog walking	yes	2000			
Bill Ovens	yes	walking, children playing	no mention	1993			
Fiona Ovens	yes	walking, children playing	no mention	1993			
Simon Ovens	yes	children playing, den building, dog walking	no mention	1993			
Ruth and Mike Hill	yes	children playing, walking	no mention	2007			community maintain area
Jill and Paul McClean	yes	children playing	no mention	4 years			
Clive and Sue Walton	yes	picnics, bonfire parties, dog walking, access to fells	yes	40 years			
Robin and Joanne O'Dowd	yes	running, walkers, dog walking	yes	2004-present time			
Clarence and Elsie Smith	yes	moving livestock	no mention	1966			do not mention village green they mention common land
Tony Smith and Elaine Watson	yes	moving livestock	no mention	40 years			doesn't mention village green or sports and pastimes.

██████████ House  
Cumrew  
CA 8 9 ██████████

24 / 5 / 2011

To Whom it may concern

My wife Shona and I have been residents in Cumrew since July 2009. We live 70 metres to the north of the Green and Lonning and have had free access to the land. Although recent incomers, we wish to strongly support the Village Green and Lonning becoming a special protected area.

I have recorded the following birds nesting in the wooded Lonning--Tawny Owl, Redstart and Blackcap. All of these are rare in Cumbria, numerous other common species also nest here or pass through as woodland migrants. Butterflies include Speckled wood and Comma, both rare in the region.

I suspect that the mature hardwood woodland of the Lonning represents ancient primary uncut forest that is very rare in Northeast Cumbria.

Yours sincerely

  
Guy and Shona Broome





CUMREW VILLAGE GREEN and FELL LONNING MAP REF. NY 552513  
(POST CODE CA8 9DD)

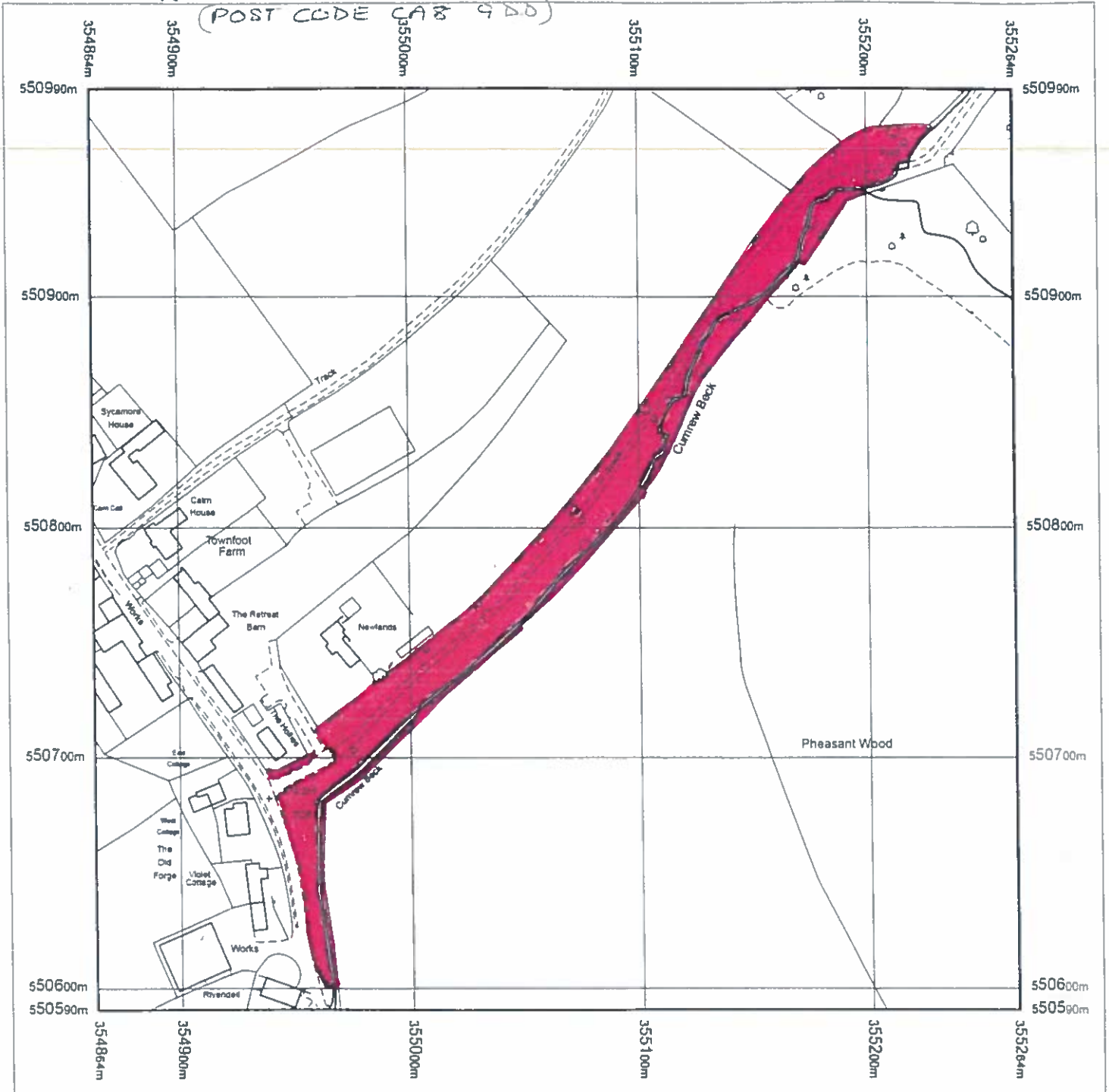

Produced 04.01.2011 from the Ordnance Survey National Geographic Database and incorporating surveyed revision available at this date. © Crown Copyright 2011.

Reproduction in whole or part is prohibited without the prior permission of Ordnance Survey

Ordnance Survey, the OS Symbol and OS Sitemap are registered trademarks of Ordnance Survey, the national mapping agency of Great Britain.

The representation of a road, track or path is no evidence of a right of way.

The representation of features as lines is no evidence of a property boundary.



Scale 1:2500

Supplied by: **Carlisle Library**  
Serial number: 00075000  
Centre coordinates: 355063.5 550790.5

Further information can be found on the OS Sitemap information leaflet or the Ordnance Survey web site [www.ordnancesurvey.co.uk](http://www.ordnancesurvey.co.uk)

[REDACTED]  
Cumrew  
Brampton  
Carlisle  
Cumbria  
CA 9 [REDACTED]

---

Re The Green & Fell Lonning Cumrew

I have lived in the village for almost 16 years, I have used the footpath opposite my house to access the fells where I walk regularly. My Grand children regularly play on the grassed area opposite my property. I am not aware of who may own the land but myself and my family have never been restricted from using it.

I would support any application that may be made to register the land as a 'village green' and would be prepared support any application if required to do so.

[REDACTED]  
Alan Sykes

5<sup>th</sup> June 2011



CUMREN VILLAGE GREEN and FELL LONNING MAP REF. NY 55251.  
(POST CODE CA8 9DD)



Produced 04.01.2011 from the Ordnance Survey National Geographic Database and incorporating surveyed revision available at this date. © Crown Copyright 2011.

Reproduction in whole or part is prohibited without the prior permission of Ordnance Survey.

Ordnance Survey, the OS Symbol and OS Sitemap are registered trademarks of Ordnance Survey, the national mapping agency of Great Britain.

The representation of a road, track or path is no evidence of a right of way.

The representation of features as lines is no evidence of a property boundary.



Scale 1:2500

Supplied by: **Carlisle Library**  
Serial number: 00075000  
Centre coordinates: 355063.5 550790.5

Further information can be found on the OS Sitemap information leaflet or the Ordnance Survey web site [www.ordnancesurvey.co.uk](http://www.ordnancesurvey.co.uk)

[REDACTED]  
Cumrew  
Cumbria  
CA8 9 [REDACTED]

---

6/6/11

To Whom it may Concern

My husband and I live at The Hollies, adjacent to the green and lonning in Cumrew, having moved here on 20<sup>th</sup> August 2006.

We have tidied rubbish and rubble from the green and cut the grass regularly, leaving areas for wild flowers in spring and early summer.

We have walked the lonning daily with our dog, enjoying the drifts of snowdrops, bluebells and other wild flowers in each season. Among the trees growing by the beck elms are regenerating.

Living adjacent to the lonning we have observed that open access is important, not just as an amenity, but for farmers to take sheep to the upland grazing areas of Cumrew Fell.

We feel that the green and lonning are very special and should be protected in order to preserve them and to allow access for everyone in the village to use and enjoy.

Yours faithfully,

[REDACTED]  
Elizabeth Fowler



CUMREW VILLAGE GREEN and FELL LONNING MAP REF. NY 55251.  
(POST CODE CA8 9DD)

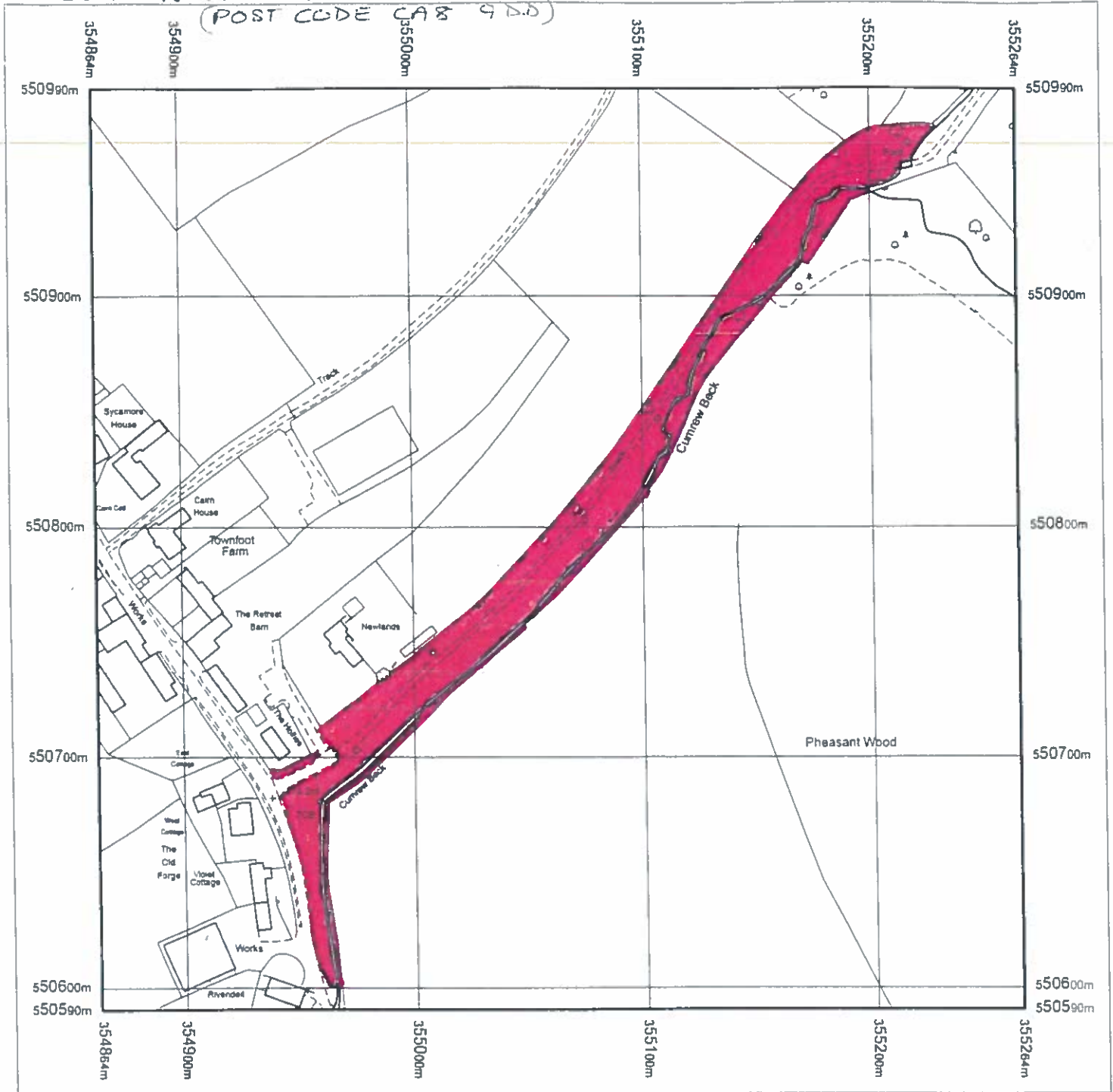

Produced 04.01.2011 from the Ordnance Survey National Geographic Database and incorporating surveyed revision available at this date. © Crown Copyright 2011.

Reproduction in whole or part is prohibited without the prior permission of Ordnance Survey.

Ordnance Survey, the OS Symbol and OS Sitemap are registered trademarks of Ordnance Survey, the national mapping agency of Great Britain.

The representation of a road, track or path is no evidence of a right of way.

The representation of features as lines is no evidence of a property boundary.



Supplied by: **Carlisle Library**  
Serial number: 00075000  
Centre coordinates: 355063.5 550790.5

Further information can be found on the OS Sitemap Information leaflet or the Ordnance Survey web site: [www.ordnancesurvey.co.uk](http://www.ordnancesurvey.co.uk)

[REDACTED]  
Cumrew  
Brampton  
Cumbria  
CA8 [REDACTED]

Tel [REDACTED]

Email [REDACTED]

13<sup>th</sup> July 2011

TO WHOM IT MAY CONCERN

**CUMREW VILLAGE FELL LONNING**

My family and I have lived in Cumrew Village for over 40 years. I confirm that we own land adjacent to the fell lonning which has two gateways which have a right of access for vehicles from the fell lonning.

The fell lonning is also used for accessing Cumrew Fell by villagers and other landowners.

We support the application for this land to be registered as common land and have the access rights protected for future generations.

Yours sincerely

[REDACTED]  
Tony Smith, Elaine Watson, James Smith and Hannah Smith



CUMREW VILLAGE GREEN and FELL LONNING MAP REF. NY 55251:  
(POST CODE CA8 9DD)

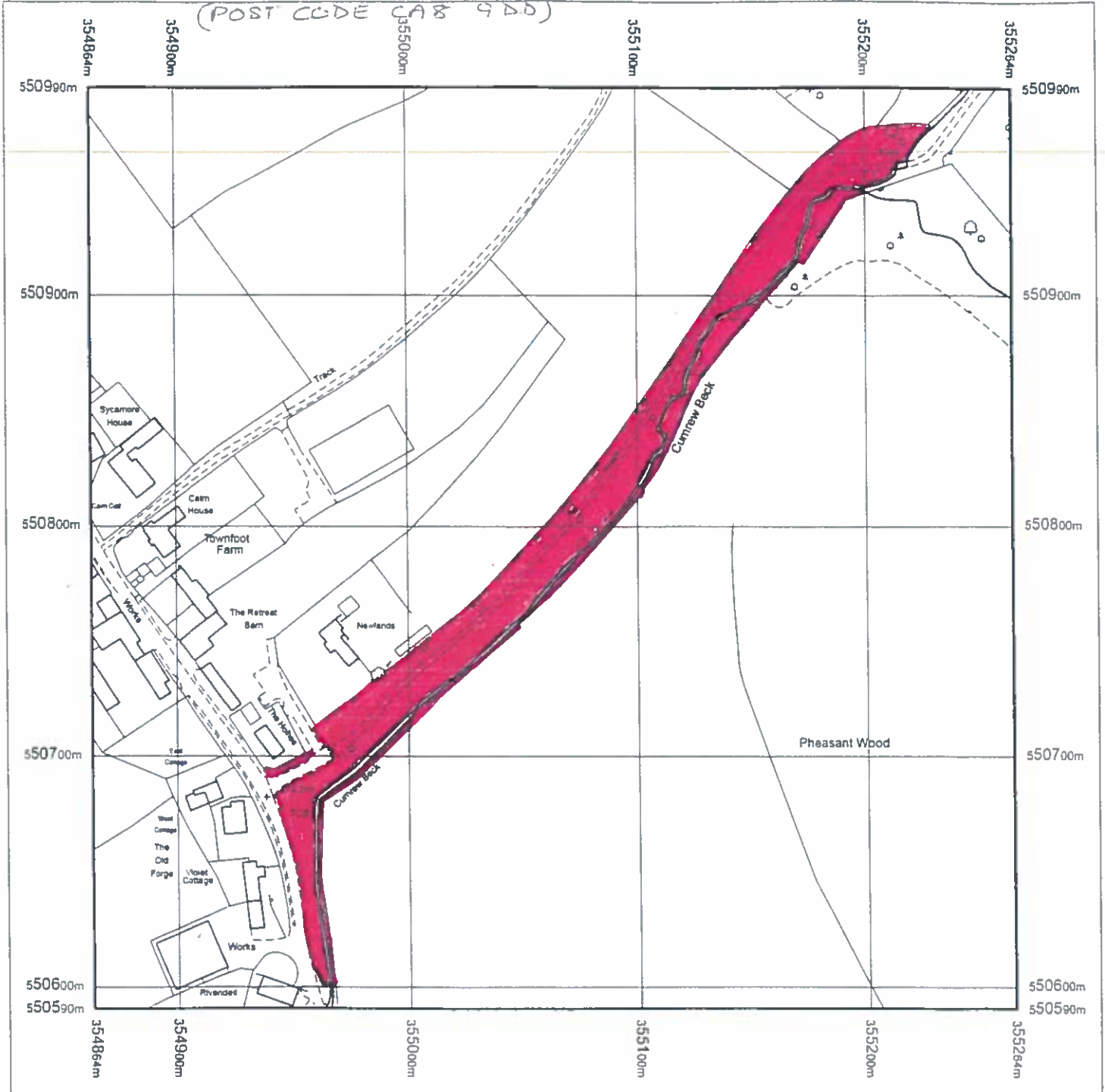

Produced 04.01.2011 from the Ordnance Survey National Geographic Database and incorporating surveyed revision available at this date. © Crown Copyright 2011.

Reproduction in whole or part is prohibited without the prior permission of Ordnance Survey.

Ordnance Survey, the OS Symbol and OS Sitemap are registered trademarks of Ordnance Survey, the national mapping agency of Great Britain.

The representation of a road, track or path is no evidence of a right of way.

The representation of features as lines is no evidence of a property boundary.

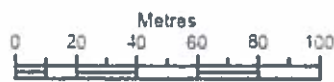

Scale 1:2500

Supplied by **Carlisle Library**  
Serial number: 00075000  
Centre coordinates: 355063.5 550790.5

Further information can be found on the OS Sitemap Information leaflet or the Ordnance Survey web site: [www.ordnancesurvey.co.uk](http://www.ordnancesurvey.co.uk)